

## SLB4-G

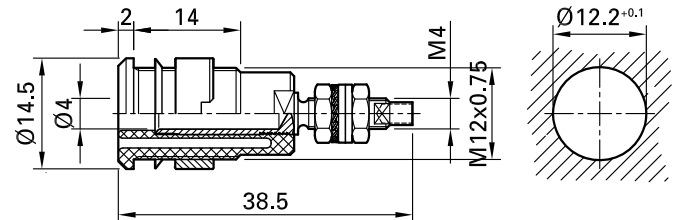

Item number 23.3020-\*

Insulated, rigid, Ø 4 mm, accepting spring-loaded Ø 4 mm plugs with rigid insulating sleeve. Machined brass. The socket is screwed into pre-drilled panels of plastic, metal, etc. Connection: Threaded bolt M4 and soldering hole.

Technical data	
Diameter of plug system	4 mm
Rated Values	1000 V, CAT III, 32 A
Surface treatment electrical contact	Au
Base material electrical contact	CuZn
Colours *	<span style="background-color: #ffff00; border: 1px solid black; padding: 2px;">20</span> <span style="background-color: #000000; color: white; border: 1px solid black; padding: 2px;">21</span> <span style="background-color: #ff0000; color: white; border: 1px solid black; padding: 2px;">22</span> <span style="background-color: #0000ff; color: white; border: 1px solid black; padding: 2px;">23</span> <span style="background-color: #ffff00; border: 1px solid black; padding: 2px;">24</span> <span style="background-color: #008000; color: white; border: 1px solid black; padding: 2px;">25</span> <span style="background-color: #800080; color: white; border: 1px solid black; padding: 2px;">26</span> <span style="background-color: #a52a2a; color: white; border: 1px solid black; padding: 2px;">27</span> <span style="background-color: #808080; border: 1px solid black; padding: 2px;">28</span> <span style="background-color: #d3d3d3; border: 1px solid black; padding: 2px;">29</span>
Thread	M4
Test accessory acc. to	IEC EN 61010-2-030
Supplied assembly material	2x MU0,8D/M4; MUR/M12x0,75; SSP4; 2x U/M4; FS/M4
Approvals	UR
Remarks	Accessories: Tube spanner SS2; Tube spanner SS425